

## Company profile Gillain & Co



## Mastering Purity

More than 140 years supplier to the high and ultra high purity





**inoxco** FOOD  
**inoxco** PURE  
**inoxco** INDUSTRY

## Gillain & Co, specialist distributor for food and pharma

### Complete assortment

- Stainless steel tubes and fittings and installation materials
- Process equipment
- Spare parts
- Maintenance

### Our customers / industries

- Pharma and cosmetics / food and dairy / beer- and soft drinks / fine chemicals and biotechnology/ photovoltaics and semi-conductors
- Installers / machine builders and tank manufacturers (OEM) / maintenance-, reparation- and revision companies
- Engineering and contractors

### Procesoptimization is always key

Our stainless steel- and process experts think along with you about the solution that suits best to your needs. They are trained to propose you products or systems that are cost efficient, consume less energy and assure a safe production process.

### Quality all along the line

Gillain & Co only sells products that are subject to a very strict quality control at the manufacturer. Upon receipt of a delivery, we perform an additional quality control according to the standards:

- Visual inspection
- Various tests: roughness, chemical composition and dimensions
- Weld inspection

We pay rigorous attention to packing, stocking, handling and transportation of the hygienic components. Your order is handled with the utmost care.

### Direct deliveries from stock

You receive your delivery within 24 hours when ordering before 11 a.m. In case you order "goods-on-demand", we assure a close follow-up and clear communication to ensure that your planning will not be compromised.

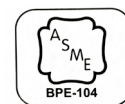

# Tubes and fittings in stainless steel, directly from stock

**INOXCO** is the private label of Gillain & Co. **INOXCO** stainless tubes and fittings are produced, controlled, marked and certified according to the highest standards. **INOXCO** is distinguished by an extremely smooth inside surface and offers multiple benefits::

1. Faster cleanability saving time and money
2. Prevention of microorganism development
3. Traceability
4. Better weldability since INOXCO fittings are annealed after forming, resulting in a significant productivity gain for the welder.
5. Roughness of INOXCO-fittings are mentioned on the certificat delivered together with the component



## Tubes and fittings

- Welded hygienic tubes and fittings
- 304L/316L
- Polished/Non-polished
- Annealed
- Internal Ra from  $\leq 0,38$  up to  $\leq 0,8 \mu\text{m}$
- European and American standards



## Valves

- Butterfly valves
- Single- and double seat valves
- 3-way valves
- Ball valves
- Sampling valves



## Hygienic couplings and seals

- Dairy, aseptic and tri-clamp couplings
- Seals available in different qualities



## Installation material

- Tube supports: square and round, standard and heavy duty
- U-bolts



## Manholes and accessories

- Complete assortment in stainless steel and steel
- Round, square or oval
- Autoclave or external
- Under pressure or pressureless
- Manholes custom built / built-in
- Grills and sight glasses



## Various

- Flanges
- Bar steel, profiles and steel
- Tools



## Flexible hoses

- Large plastic and stainless steel assortment





# Process equipment: a perfect mix of strong partnerships and customer care

Cost efficiency, energy saving, reduced use of water and detergents, easy maintenance and safety are important issues that we consider when selection your solution. Our process expert gives adequate answers and supports you when selecting the best performing product or system for your specific application. You can always count on fee expert advice.

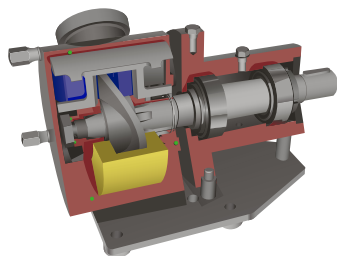

- **Pumps and pump systems**
- **Valves + valve automation**
- **Mixers**
- **Magnetic mixers**
- **Heat exchangers**
- **Drum unloading units**
- **Homogenisers**
- **Foam cleaning installations**
- **Pigging systems**
- **Filters - fine filters - microfiltration**
- **CIP- and SIP-modules**
- **Biowaste-systems**
- **Instrumentation**
- **Spare parts**
- **Maintenance: preventive and reactive**





## Our warehouse

- Dynamic storage system with more than 5,000 stock locations giving a perfect traceability
- Dust-free storage, protected from light and dust
- 4,000 m<sup>2</sup> storage surface with a height up to 10 metres for tubes
- Warehouse for tubes with 520 storage locations
- More than 1,000 tons of tubes and fittings
- 100% of our power usage is delivered by solar energy



## At our customers' premises

Tubes, fittings and specialised parts from our house brand INOXCO are used in hygienic process lines in Belgium and throughout the world.

Process equipment of international brands are delivered via Gillain & Co to food and pharma companies.







## Contact us

T: +32 3 870 60 80  
F: +32 3 870 60 87  
E: [advice@gillain.com](mailto:advice@gillain.com)  
www.gillain.com

Gillain & Co  
Boomsesteenweg 85  
2630 Aartselaar  
Belgium



Stay informed on our latest product news and promotions!  
Subscribe to our newsletter via [advice@gillain.com](mailto:advice@gillain.com)



**Gillain & Co**  
HYGIENIC EQUIPMENT FOR FOOD & LIFE SCIENCES

part of  
**heleon**  
group